

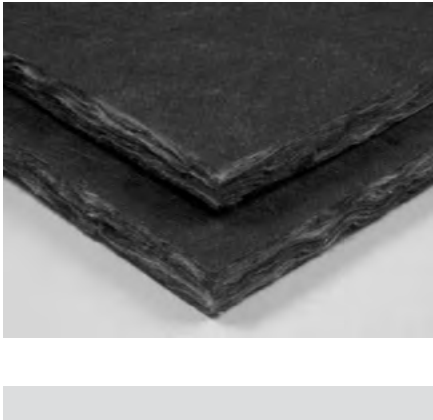

SelectSound® Black Acoustic Blanket

Product Data Sheet



Outstanding Acoustical Performance

SelectSound Black acoustic blanket provides excellent acoustical performance for walls in multiplex theaters, sound studios and performing arts centers. SelectSound Black acoustic blanket is also ideal for use above suspended metal ceiling systems. Depending on specified thickness, SelectSound Black acoustic blanket absorbs up to 80% of the sound striking its surface.

SelectSound Black acoustic blanket helps provide the highest quality audio reproduction by reducing sound reverberation within spaces. Sound transfer from space to space is also noticeably reduced.

Durable Material Composition

SelectSound Black acoustic blanket is dimensionally stable and will not shrink or warp. The blanket's resilient composition resists job-site damage. Composed of a mix of glass fibers, SelectSound Black acoustic blanket will not rot or mildew and is noncorrosive to steel, copper and aluminum. As manufactured, fiber glass insulation is resistant to mold growth, however, mold growth can occur on building materials, including insulation, when it becomes

contaminated with organic material and when water is present. To avoid mold growth on fiber glass insulation, remove any water that has accumulated and correct or repair the source of the water as soon as possible. Insulation that has become wet should be inspected for evidence of residual moisture and contamination, and any insulation that is contaminated should be promptly removed and replaced.

Fast, High Quality Installation

This wider product improves job site productivity and requires less seams. Lightweight and resilient, SelectSound Black acoustic blanket is easy to handle, fabricate and install. Both stick pins and adhesives can be used to secure insulation to drywall, concrete block or precast concrete.

Size Availability

SelectSound Black acoustic blanket is available in standard thicknesses of 1" and 2". A 1½" thickness is available through special order.

The 1" and 1½" product is available in 72" W x 70' L rolls, while the 2" product is available in a 72" W x 50' L roll.

All Black Fiber with Black Mat Finish

SelectSound Black acoustic blanket is an all black fiber product with a black mat surface. It is excellent for eliminating light reflections while providing outstanding acoustical performance.

Design Considerations

Acoustical performance of interior surfaces can generally be improved by increasing product thickness. SelectSound Black acoustic blanket can be specified for use in conjunction with other Owens Corning acoustical material to provide additional performance.

Applicable Standards

SelectSound Black acoustic blanket complies with the property requirements of ASTM C553, Type III, 250°F maximum use temperature.

The noise reduction coefficients of SelectSound Black acoustic blanket were derived from tests conducted in accordance with ASTM C423 on a Type A mounting. Meets New York City MEA No.306-03-M.

Installation Procedure

Typical Physical Properties

Property	Test Method	Value
Water Vapor Sorption (by weight)	ASTM C1104	<3% by weight at 120°F (49°C), 95% R.H.
Fungi Resistance	ASTM C1338	Meets Requirement
Corrosiveness	ASTM C665 Corrosiveness Test	Will not cause corrosion greater than that caused by sterile cotton on aluminum or steel ¹
Surface Burning Characteristics	UL723 ² , or CAN/ULC-S102-M ²	
Flame Spread		25 ²
Smoke Developed		50
Maximum Air Velocity	UL181 Erosion Test	6,000 fpm (30.5 m/sec.)

¹When wet, coated surfaces in contact with galvanized steel may cause discoloration of the sheet metal.

²The surface burning characteristics of these products have been determined in accordance with UL723 and CAN/ULC-S102-M. These standards should be used to measure and describe the properties of materials, products or assemblies in response to heat and flame under controlled laboratory conditions and should not be used to describe or appraise the fire hazard or fire risk of materials, products or assemblies under actual fire conditions. However, results of this test may be used as elements of a fire risk assessment which takes into account all of the factors which are pertinent to an assessment of the fire hazard of a particular end use. Values are reported to the nearest 5 rating.



SelectSound® Black Acoustic Blanket

Product Data Sheet

SelectSound Black acoustic blanket can be installed on drywall, concrete block or precast concrete using impaling pins or appropriate adhesives.

When installing insulation with adhesive, follow adhesive manufacturer's recommendations for surface preparation and pattern.

When using impaling pins, follow the pin manufacturer's recommendations for surface preparation, location and amount of pins. Pin length should be selected to ensure tight fit. Where subject to physical contact, protect pin tips.

Keep product dry during shipping, storage and installation.

Owens Corning reserves the right to change this product as needed.

Caution: May cause temporary irritation to skin, eyes and respiratory tract. Avoid contact with eyes and skin. Wear long-sleeved, loose-fitting clothing, gloves and eye protection when handling and applying material. Wash with soap and warm water after handling. Wash work cloths separately and wipe out washer.

Conceptual Details

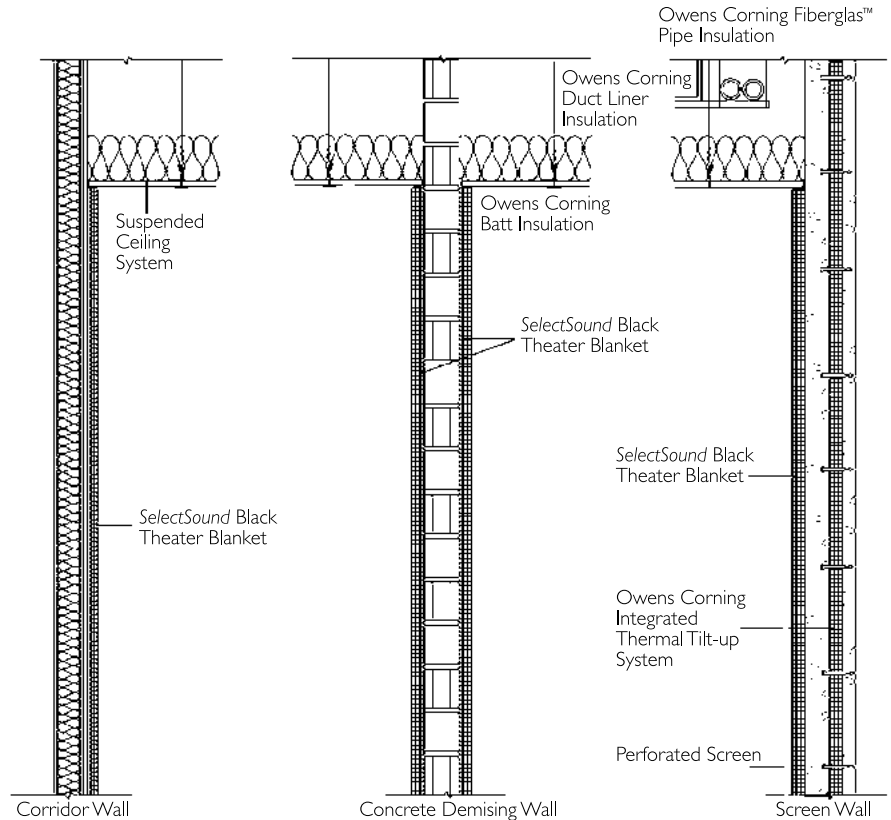

For CSI type sample specification, please contact your local Owens Corning representative.

Acoustical Performance

Tested Values - SelectSound Black Acoustic Blanket

Sound Absorption Coefficients (ASTM C423, Type "A" Mounting)

Product	Density		Thickness		Octave Band Frequencies, Hz.							Thermal Resistance ¹ R-Value (hr•ft ² •°F)/Btu
	pcf	kg/m ³	in	mm	125	250	500	1000	2000	4000	NRC*	
SelectSound Black 150B	1.5	24	1.0	25	0.08	.025	0.49	0.72	0.86	0.91	0.60	3.8
Acoustic Blanket	1.5	24	1.5	38	0.16	0.36	0.61	0.83	0.90	0.92	0.70	5.8
			2.0	51	0.20	0.53	0.79	0.94	0.95	0.97	0.80	7.7
			2.0	51	0.20	0.55	0.87	1.00	0.95	0.95	0.85	8.0

¹ASTM C518

These data were collected using a limited sample size and are not absolute values. Reasonable tolerances must therefore be applied. All tests were conducted in accordance with ASTM C423, Type A mounting (material placed against a solid backing such as a block wall). Owens Corning Granville Science & Technology Acoustics Lab is National Voluntary Laboratory Accreditation Program (NVLAP) accredited, under lab code 100109-0.



OWENS CORNING INSULATING SYSTEMS, LLC
 ONE OWENS CORNING PARKWAY
 TOLEDO, OHIO 43659
1-800-GET-PINK®
www.owenscorning.com

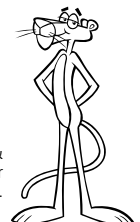

Pub. No. 44089-F. Printed in U.S.A. May 2014. THE PINK PANTHER™ & ©1964-2014 Metro-Goldwyn-Mayer Studios Inc. All Rights Reserved. The color PINK is a registered trademark of Owens Corning. © 2014 Owens Corning. All Rights Reserved.